

Job:

Approval:

Type:

# VISION3

## LIGHTING

LED Dual Staff Light **MODEL PA17**  
120-277V, 15W Max. ea., Dual Integral Driver COB LED  
30W Max. ea., Dual COB LED (Remote Drivers Required)

### Specifications

#### Material

Available in machined 6061-T6 aluminum with 18-8 stainless steel hardware.

#### Head

Machined heads come in two styles: Side Mount and Rear Mount. (See illustration for aiming capability of each head style.)

#### Stem

Machined stems available in lengths of 3", 6", 12", 18", 24", 30", 36", 42" and 48". Maximum allowable stem length depends on mount option (see **Ordering Information**). Soil type and installation manner may limit safe stem length further. To prevent fixture from toppling over, these factors must be taken into account when choosing stem length, mount type, or installation manner (concrete anchoring may be required).

#### Knuckle

A Rotate and Lock knuckle (protected under U.S. Patents #6,966,679, #7,108,405 and #7,458,552) mounts each head and allows for adjustability. Double taper design allows fixture to hold position during aiming and ensures a solid lock when tightened. Molded silicone compression seals at knuckles prevent moisture entry around wires.

#### Cap

Machined caps come in seven styles, lock in place with one 18-8 stainless steel set screw, and are sealed to the body with a high temperature silicone O-ring. Regress Lens caps have drain holes for water drainage from top of lens if mounted in the up position. All caps accept two internal accessories, held in place by a stainless steel clip.

#### Finish

TGIC thermo set polyester powder coat paint available in 14 standard colors. Finish is applied over a corrosion resistant, hexavalent chromium free, RoHS compliant coating. Also available in one additional metal finish: Clear Anodized.



#### Lens

Each cap contains a 1/8" thick tempered, clear lens, secured with a high temperature, UV curing, silicone adhesive.

#### Light Engines<sup>8</sup>

Both COB LED light engine options use industry standard replaceable components and quick disconnects for ease of field maintenance and future upgrades, and includes features like: field changeable optics (15°, 24°, 36°, 55°, 65°), choice of color temperature (2700K, 3000K, 3500K, 4000K), CRI (80, 90), and an L70 > 50,000 hrs.

**Integral Driver COB LED option:** Each head includes a field replaceable driver module with a 350mA, 15W max Class 2 driver for features like: 1600lm max. nominal output, 105 lm/W efficacy, 120-277VAC (50/60Hz) input, programmable tri-dimming (TRIAC, ELV, 0-10V) down to 1%, and various protection features (input over current, short circuit and over current, internal over temperature, output open load). Notes: driver can be programmed for dimming profile or lower lumen output. Contact V3 for info. For compatible dimmers, see Compatible Dimmer list.

**Remote Driver COB LED option:** Requires Vision3 approved constant current dual driver mount (specified below). Includes performance of 1800lm @ 350mA, 2400lm @ 500mA, or 3200lm @ 700mA (values for each head). Note: see specification sheet of driver mount for appropriate driver ratings.

#### Certification

CSA tested & certified to US and Canadian safety standards for wet location landscape use per UL1598.

All ratings subject to change without notice. See web site or contact V3 for most current info.

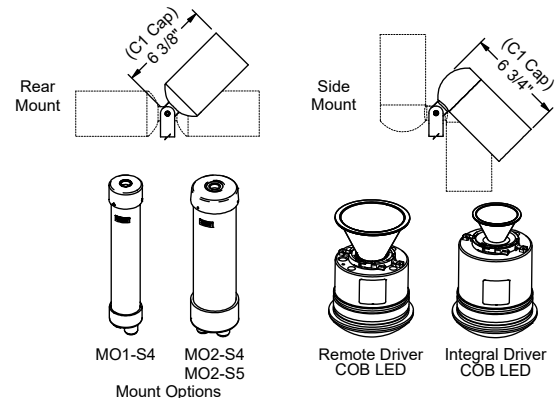
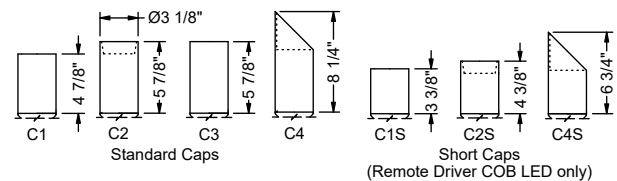
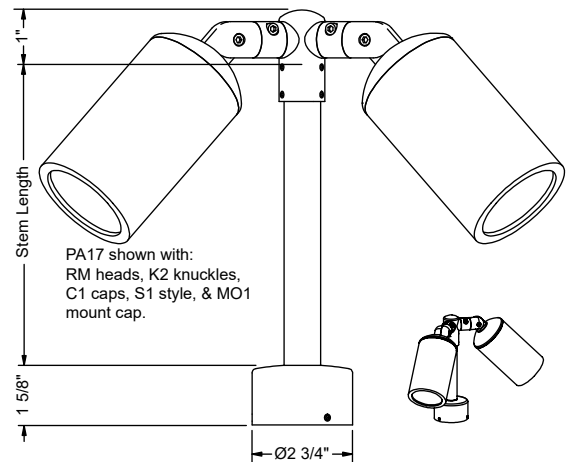

### Ordering Information

PA17A	Head	Cap Style <sup>7</sup>	Style	Stem <sup>3</sup>	Light Engine <sup>7</sup>	Lens Accy <sup>7</sup>	Louver <sup>7</sup>
Model PA17A	SM - Side Mount RM - Rear Mount	Standard Caps: C1 - Flush C2 - Regress Lens C3 - Regress Lamp C4 - 45° Angled	S1 - Straight	6 - 6" 12 - 12" 18 - 18" 24 - 24" 30 - 30" 36 - 36" 42 - 42" 48 - 48"	LED <sup>6</sup> X - X - X - X	0 - None L1 - Spread L2 - Linear L3 - Softening	0 - None H1 - Hex
Finish	Knuckle <sup>1</sup>	Short Caps <sup>2</sup> : C1S - Flush C2S - Regress Lens C4S - 45° Angled	Mount <sup>4,6</sup>				
<b>Powder Coat Finishes:</b> BLT - Textured Black BNT - Textured Bronze BAT - Textured Bark GRT - Textured Green GNT - Textured Granite SAT - Textured Sand PAT - Textured Patina EAT - Textured Earth	BL - Black BN - Bronze WI - White SI - Silver GY - Grey BE - Beige						
<b>Metal Finishes:</b> CLA - Clear Anodized							

#### Notes:

- K2 knuckle is protected under U.S. Patents #6,966,679, #7,108,405, & #7,458,552.
- Short cap options only available with Remote Driver COB LED options.
- Other stem lengths are available upon request. Contact Vision3.
- See mount specification sheet for mount details.
- SN mount option requires that a separate mount be used.
- Mount type must match Light Engine LED type.
- Cap Style, Light Engine, Lens Accy, and Louver options specified will be used for each head. To use different options for each head, contact Vision3.
- All lumen values cited are nominal lumen output (ideal lumen output of light engine only in lab conditions). Actual fixture output will vary with cap type, material, lens/optics options, and environmental conditions. For more accurate information, see fixture photometry files on website.
- Specifications, certifications, and ordering information are subject to change. Please check website for latest specification sheets.

#### Remote Driver COB LED light engines only (48" max stem):

MO1-S0 - No Mount (MO1 Cap Only, 36" max. stem)  
MO1-S4-12 - 12" MO1 Junction Mount (36" max. stem)  
MO1-S4-18 - 18" MO1 Junction Mount (36" max. stem)  
MO2-S4-12 - 12" MO2 Junction Mount (48" max. stem)  
MO2-S4-18 - 18" MO2 Junction Mount (48" max. stem)

#### Integral Driver COB LED light engines only (48" max stem):

MO2-S5-12-2X15-UNV-350-TRI - 12" MO2 Junction w/ Dual 15W max, 120-277V, 350mA Drivers  
MO2-S5-12-2X30-UNV-500-TRI - 12" MO2 Junction w/ Dual 30W max, 120-277V, 500mA Drivers  
MO2-S5-12-2X30-UNV-700-TRI - 12" MO2 Junction w/ Dual 30W max, 120-277V, 700mA Drivers  
MO2-S5-18-2X15-UNV-350-TRI - 18" MO2 Junction w/ Dual 15W max, 120-277V, 350mA Drivers  
MO2-S5-18-2X30-UNV-500-TRI - 18" MO2 Junction w/ Dual 30W max, 120-277V, 500mA Drivers  
MO2-S5-18-2X30-UNV-700-TRI - 18" MO2 Junction w/ Dual 30W max, 120-277V, 700mA Drivers

**Integral Driver COB LED:**  
LE1-1600 - 15W, 1600lm<sup>8</sup> 8 - >80 27 - 2700K 15 - 15°  
LE1-1200 - 11W, 1200lm<sup>8</sup> 9 - >90 30 - 3000K 24 - 24°  
**Remote Driver COB LED:**  
C01 - Remote Driver COB LED 35 - 3500K 36 - 36°  
40 - 4000K 55 - 55°  
65 - 65°

Example: PA17A - BL - SM - K2 - C4 - S1 - 24 - MO2-S5-12-2X30-UNV-500-TRI - C01-8-30-25 - L1 - H1

©2011 - 2024 Vision3 Lighting®

P.O. Box 607, Fowler, CA 93625

(559) 834-5749

(559) 834-4779 fax

www.vision3lighting.com

revision 12/4/24